

PROGRAM SUMMARY

PROPOSED DEVELOPMENT:	Use	Area	Parking Req.
	Residential: M55+ [225du]	260,000sf	[1.0/du]
	Retail	50,000sf	[4.0/1,000]
	Restaurant	20,000sf	[7.0/1,000]
	Supermarket	35,000sf	[5.0/1,000]
	Office	150,000sf	[3.3/1,000]
	Hotel [100 keys]	65,000sf	[1/key+]
	Community Space	5,000sf	[4.0/1,000]
	Fitness	15,000sf	[3.3/1,000]

TOTAL **600,000sf** **1,407 spaces***

* Per TEC ULI mixed-use shared parking calculation

PARKING PROVIDED:	Area
Lower Garage Level [El. 107]	514
Upper Garage Level [El. 118]	537
On-grade	366
TOTAL	1,417

GRAPHIC SCALE

[1 inch = 50 feet]

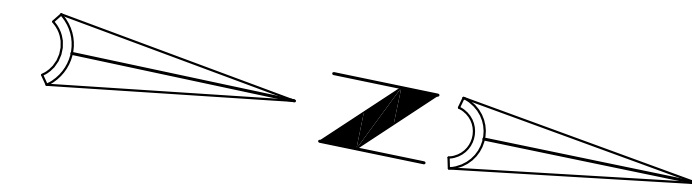

3/25/2013 5:23:55 PM

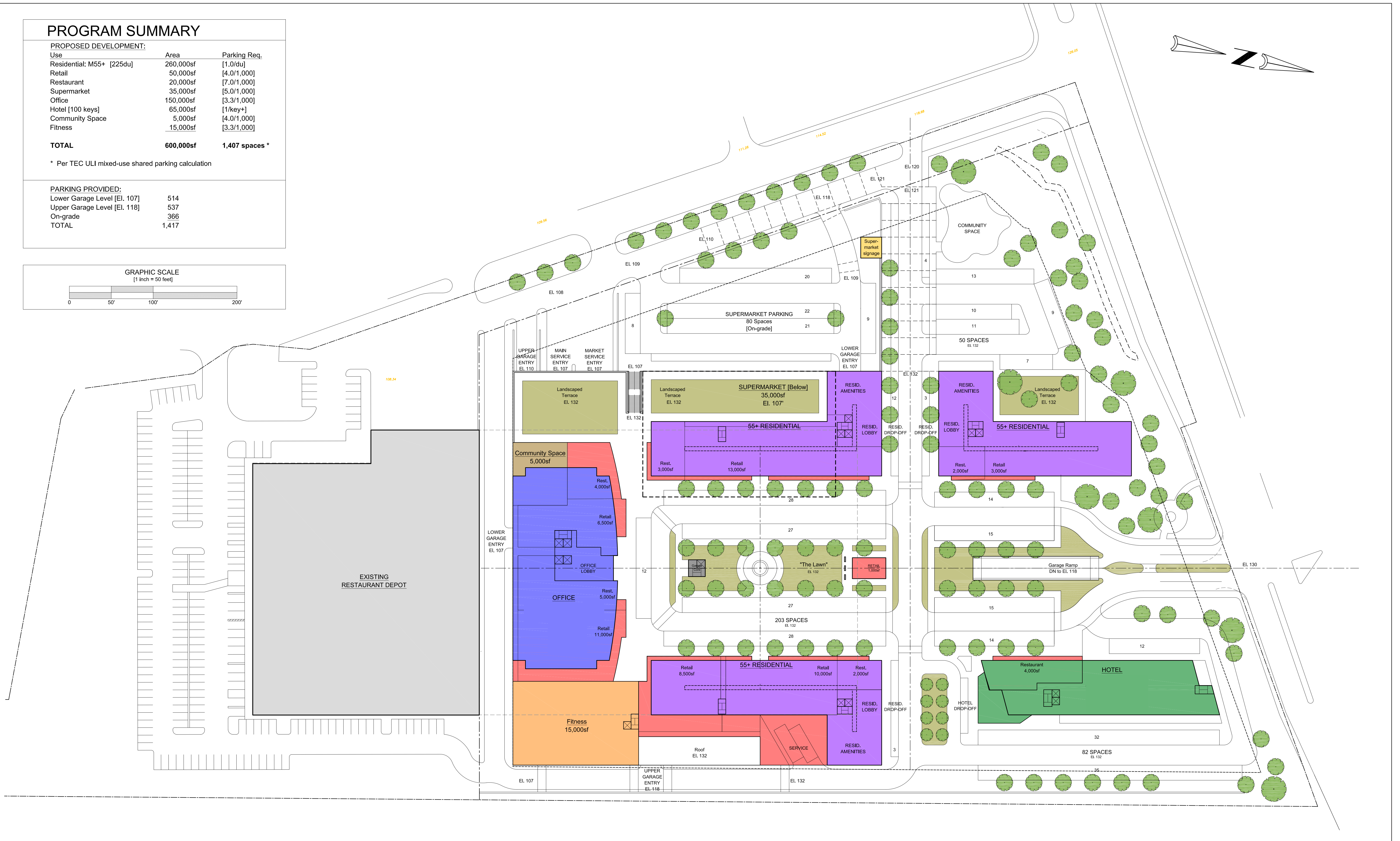

797 Washington Street, Suite 3
 Newtonville, MA 02460
 (617) 795-1965



ANDOVER MIXED-USE

146 Dascomb Road
 Andover, MA

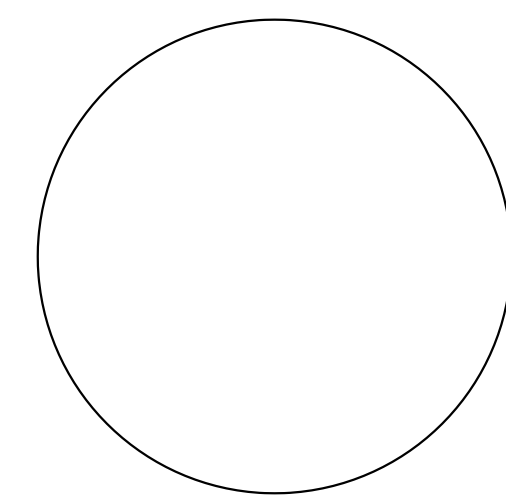

Project Number	16040
Author	MW
Checker	
Issue date	1 NOVEMBER 2017
Scale	1" = 50'-0"

Revisions

No.	Date	Description

Drawing Title

PUD SITE PLAN

Drawing Number

Scheme A.2

24" x 36"